

Liquid Storage & Export Facility Opportunity

389.11 +/- Acres – Mid-Houston Ship Channel

FOR LONG TERM LEASE

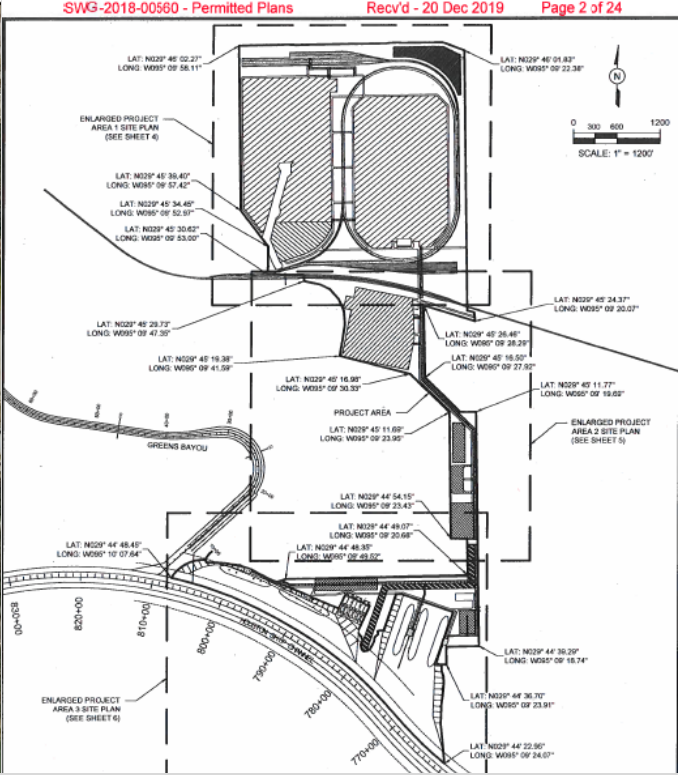

Features

- Size:** 389.11 +/- Acres
- Land:** USACE Permitted Greenfield
- Foreign Trade Zone:** 16 grandfathered acres
- Ship Channel Access:** Yes
- Property Location:** Interstate-10 at Penn City Road Houston, TX at Preferred Mid-Channel
- Rail Accessible:** UP & PTR

- Channel Depth:** 40' with 45' in 2022
- Permitted Ship Docks:** 5 with two Suez Max capable
- Barge Docks:** 6
- Pipeline Connectivity:** Multiple carriers
- Storage Capacity:** 20M +/- Barrels



Directions

From Downtown Houston go I-10 E towards East Beltway-8, exit 781A. follow East Freeway service road to Penn City Road. Turn right and proceed down Penn City Road. Property will be on the right side

For more info contact Port Houston Real Estate:

Call 713-670-2679 or email rdtanner@porthouston.com



PORT HOUSTON™
THE INTERNATIONAL PORT OF TEXAS

The Port Authority makes no guarantee, warranty or representation about the information contained herein. Any projections, opinions, assumptions or estimates used are for example only and do not represent the current or future performance of the property. You and your advisors should conduct a careful, independent investigation of the property to determine to your satisfaction.